



**SUCTION HOSES FOR THE WOODWORKING INDUSTRY
HARDLY INFLAMMABLE AC: TO DIN 4102B1
FLAMEX B-se**



Spiral hose made from polyester polyurethane-hardly inflammable acc. to DIN 4102B1

MATERIAL:

Hose wall: 100 % pure polyester polyurethane with addition of flame protector

Spiral: spring steel wire

APPLICATIONS:

- Transport hose for abrasive solids in fire risk areas
- Woodworking machines
- exhaust equipment in woodworking industries
- Protection hose against mechanical pressure.

PROPERTIES:

- Conforms to the Requirements of the German professional woodworking association
- Extremely abrasion-resistant

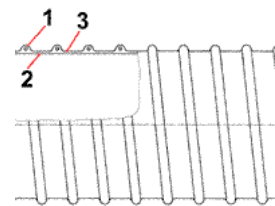

FLAMEX BF-se

Spiral hose made from polyester polyurethane-hardly inflammable acc. to DIN 4102B1

MATERIAL:

Hose wall: 100 % pure polyester polyurethane with addition of flame protector

Spiral: spring steel wire

APPLICATIONS:

- Transport hose for abrasive solids in fire risk areas
- Woodworking machines
- exhaust equipment in woodworking industries
- Protection hose against mechanical pressure.

PROPERTIES:

- Conforms to the Requirements of the German professional woodworking association
- Extremely abrasion-resistant and flexible

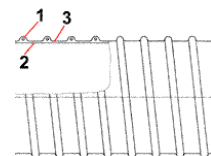

MASTER –PUR STEP

film hose made form polyurethane hardly inflammable acc. to DIN 4102B1

MATERIAL:

Hose wall: 100 % pure polyester polyurethane with addition of flame protector

Spiral: spring steel wire

APPLICATIONS:

- ideally suitable as suction hoses where conventional hoses can be deformed by bad operation conditions on the floor

PROPERTIES:

High resistance to mechanical load/ Highly abrasion-resistant

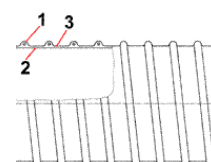



The above mentioned data refers to an average and ambient temperature of 20° C. Subject to technical changes and colour variations. Other dimensions available

FLAMEX B-se
FLAMEX BF-se

Art.No.	DN	workpressure ca. bar	low pressure ca. mm WG	bending radius ca. mm	outer -d ca. mm	weight ca. kg/m
120-060-601	60	1,260	3150	68	68	0,50
120-080-601	80	0,880	2100	88	88	0,65
120-120-601	120	0,630	1575	129	129	1,00
120-160-601	160	0,500	1050	170	169	1,42
120-225-601	225	0,250	525	235	235	2,18
120-315-601	315	0,230	457	325	325	3,32
120-500-601	500	0,120	370	510	511	5,70

MASTER-PUR STEP

Art.No.	DN	workpressure ca. bar	low pressure ca. mm WG	bending radius ca. mm	outer -d ca. mm	weight ca. kg/m
310-060-601	60	0,760	1900	35	68	0,36
310-080-601	80	0,530	1300	45	88	0,53
310-120-601	120	0,380	950	65	129	0,80
310-160-601	160	0,300	650	85	169	1,10
310-225-601	225	0,150	300	118	235	1,25
310-350-601	350	0,120	250	180	360	244

CONNECTING AND INSTALLATION ELEMENTS

Art.No.	DN	workpressure ca. bar	low pressure ca. mm WG	bending radius ca. mm	outer -d ca. mm	weight ca. kg/m
311-060-618	60	0,760	1900	65	80	0,45
311-120-618	120	0,380	950	120	140	0,95
311-140-618	140	0,300	650	140	160	1,15
311-160-618	160	0,300	650	160	180	1,30

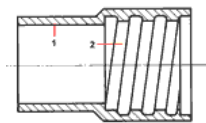

PU-sleeve,
fixed

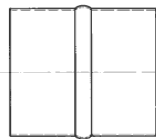

hose
connector

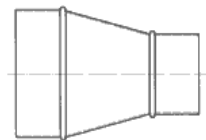

hose reducer,
symmetrical

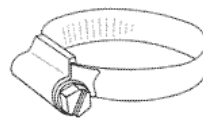

hose clamp
with worm
wheel drive



hose clamp
with round
pins

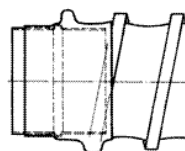

Heat shrink
sleeve

